

泳池专用差压表

YCB

Differential pressure gauge for swimming pool

产品特性：

轴向
塑料外壳、铜内机
测压原件镀铜膜片
精度等级 5 %
测量规格 0-100KPa; 0-200KPa;
仪表连接 NPT1/8 ;NPT1/4
最大电压 24V,最大电流 5A

仪表型号标示 Instrument Type

YCB-050. ZO. 103

Feature

Back connection
Plastic case brass internals
Measurement element beryllium copper
Accuracy 5%
Range 0-100kpa; 0-200kpa.
Connection NPT1/8;NPT1/4
Crest voltage 24V, peak current 5A



几何尺寸 DIMENSIONS

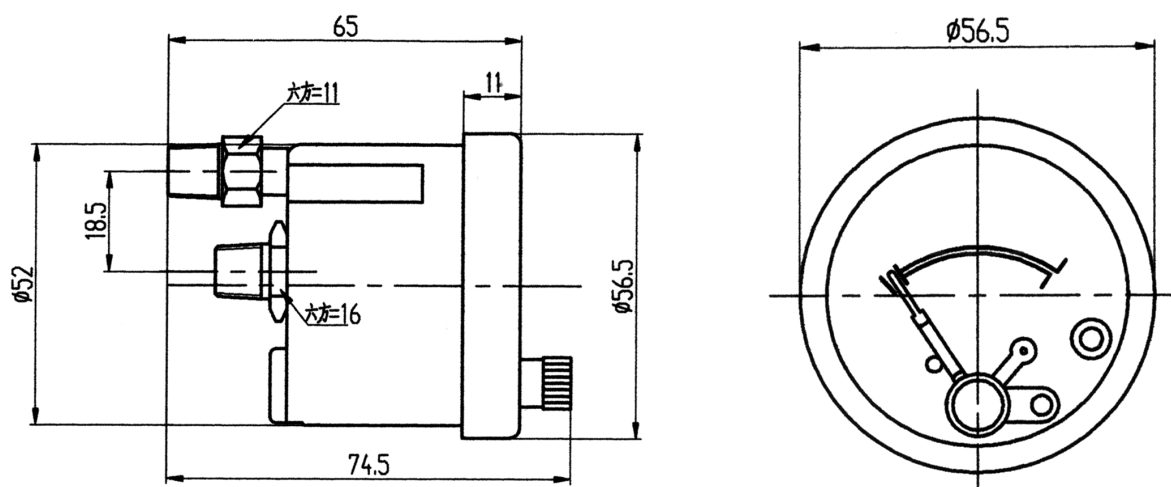

电接点压力表系列

Electric contact pressure gauge series

简介

电接点压力表被广泛应用于石油、化工、冶金、电站等工业部门或机电设备配套中测量无爆炸危险的各种流体介质的压力。

电接点压力表通常与相应的电气器件（如继电器及接触器）配套使用。

仪表由测量系统、指示装置、电接点组件装置、外壳、调整装置和接线盒（插头座）等组成。

仪表的工作原理是基于测量系统中的弹簧管在被测介质的压力作用下，产生位移，通过齿轮传动机构将被测值在度盘上指示出来。与此同时，仪表指针带动动触头与设定指针上的定触头（上限或下限）相接通（或切断），致使控制系统中的电路得以断开或接通，以达到自动控制和发信报警的目的。

Brief

Electric contacts pressure gauge is widely used to petrochemical, chemical, metallurgical electric power fields and so forth, or applied to measurement pressure of fluid medium in the machine.

Introduction

Usually, electric contact pressure gauge matches with relevant electrical apparatus, for instance, relay and contactor.

The instrument is consisted of measurement system, indicating system, electric contact parts system, case, adjustment system, junction box (socket) and otherwise.

The principle is that under the conditions of medium pressure, bourdon tube will show the measured value in the dial by gear wheel equipment. In the meanwhile, the pointer of instrument will make dynamic contact touch or cut with static one (upper limits or lower limits), leading to the cut and turn-on of control system for the purpose of automatic control and alarm.

目录

型号 Model	原型号 Original model	名称特性 Name feature	索引页 Page
YX;YXC	YX;YXC	普通电接点压力表 Normal electric contact pressure gauge	PD.01-2
YXH;YXHN	YXC-H; YXCN-H	不锈钢防腐 / 不锈钢防震电接点压力表 Stainless steel corrosion-proof / Vibration-proof electric contact pressure gauge.	PD.01-6
YXA	YXCA	氨用电接点压力表 Ammonia electric contact pressure gauge.	PD.01-10
YX;YXC;YXH; YXHN;YXA		选型表 Table of type selection	PD.01.12
BXN	YPXCN	膜片式充油防震微压电接点压力表 Capsule oil-filling vibration-proof low pressure electric contact gauge.	PD.01-13
YXDH;YXDHN	YXC-H; YXCN-H	不锈钢多接点式压力表 Stainless steel multiple contacts pressure gauge.	PD.01-16
选型表 Table of type selection			PD.01-19
量程范围规格代码表 Table of range code			PD.01-20

